

MAINSBOOST

iTank

Installation, Operation & Maintenance Instructions

Please leave this instruction booklet with the home owner as it contains important guarantee, maintenance and safety information



Read this manual carefully before commencing installation.

This manual covers the following products:

MBI 320C

Pt. No. 47124

MBI 490A

Pt. No. 47126

MBI 330T

Pt. No. 47125

MBI 500S

Pt. No. 47127

**Please note images are representative only and
may not portray your model**



PRODUCT DESCRIPTION

The iTank range is a water pressure and flow booster set with integral water storage tank and electric motor driven centrifugal pump complete with an automatic control system, consisting of flow switch, pressure switch, pressure vessel and electronic control. The design of the tank incorporates an AC air gap for fluid isolation (BS EN 1717).

APPLICATION

The Mainsboost iTank range is designed to meet the demand of pressurised systems in domestic applications where the existing mains water supply is insufficient. **Inlet pressures to the tank and ambient temperatures must not exceed the values given in the technical specifications.**

STORAGE

If this product is not to be installed immediately on receipt, ensure that it is stored in a dry, frost and vibration free location in its original packaging.

CONTENTS

	Page
Checklist5
Important Facts – read before commencing installation6
Location7
Key Features9
Assembly, Installation & Connections10
Electrical Installation15
Commissioning18
Maintenance20
Technical Specification22
Trouble Shooting23
Mainsboost iTank Accessories24
Guarantee25

WARNINGS:



- This pump set must not be used for any other application without the written consent of Stuart Turner Limited.
- This appliance can be used by children aged from 8 years and above and persons with reduced physical, sensory or mental capabilities or lack of experience and knowledge if they have been given supervision or instruction concerning use of the appliance in a safe way and understand the hazards involved.
- Children shall not play with the appliance.
- This product should not be used for the supply of water to more than one dwelling (house, apartment, flat).
- Cleaning and user maintenance shall not be made by children without supervision.
- Maximum head (closed valve) 35 metres.
- Ensure the pump or controller cannot be subjected to freezing conditions as damage will result.
- Never run pump whilst sucking air/liquid as the motor will overheat. To prevent this from happening always install pump in the vertical position and ensure fully submerged.
- The motor casing can become very hot under normal operating conditions. Care must be taken to ensure it cannot be touched during operation.
- The electrical installation must be carried out in accordance with the current national electrical regulations.



- The electrical installation must be installed by a qualified person.
- In the interests of electrical safety a 30 mA residual current device (R.C.D. not supplied) should be installed in the supply circuit. This may be part of a consumer unit or a separate unit.



- Before starting work on the electrical supply ensure power supply is isolated.
- Isolate all appliances in the water from the electrical supply before putting your hands in the water.
- DO NOT allow the supply cord to contact hot surfaces, including the motor shell, pump body or pipework. The cord should be safely routed and secured by cable clips.
- This appliance must be earthed via the supply cord, which must be correctly connected to the earth point located in the terminal box.
- The supply cord and internal wiring within the terminal box are routed and secured to ensure compliance with the electrical standard EN 60335-1. It is essential that prior to any disturbance of this internal wiring, all cable routing and securing details are carefully noted to ensure re-assembly to the same factory pattern is always maintained.
- Do not run the pump dry.
- In the unlikely event of mechanical seal failure pollution of the liquid could occur due to the leakage of lubricants.
- If the supply cord is damaged, it must be replaced by Stuart Turner Ltd or an official Service Agent to avoid hazard.
- In order to avoid toppling over the appliance must be placed on a smooth, level surface to fully support the base of the tank. It must not be positioned solely on beams/joists.

Please read installation details carefully as they are intended to ensure this product provides long, trouble free service. Failure to install the unit in accordance with the installation instructions will lead to invalidation of the warranty.

CHECKLIST

IMPORTANT: With the appliance removed from its packaging check for any damage prior to installation. If any damage is found contact Stuart Turner Ltd within 24 hours of receipt.

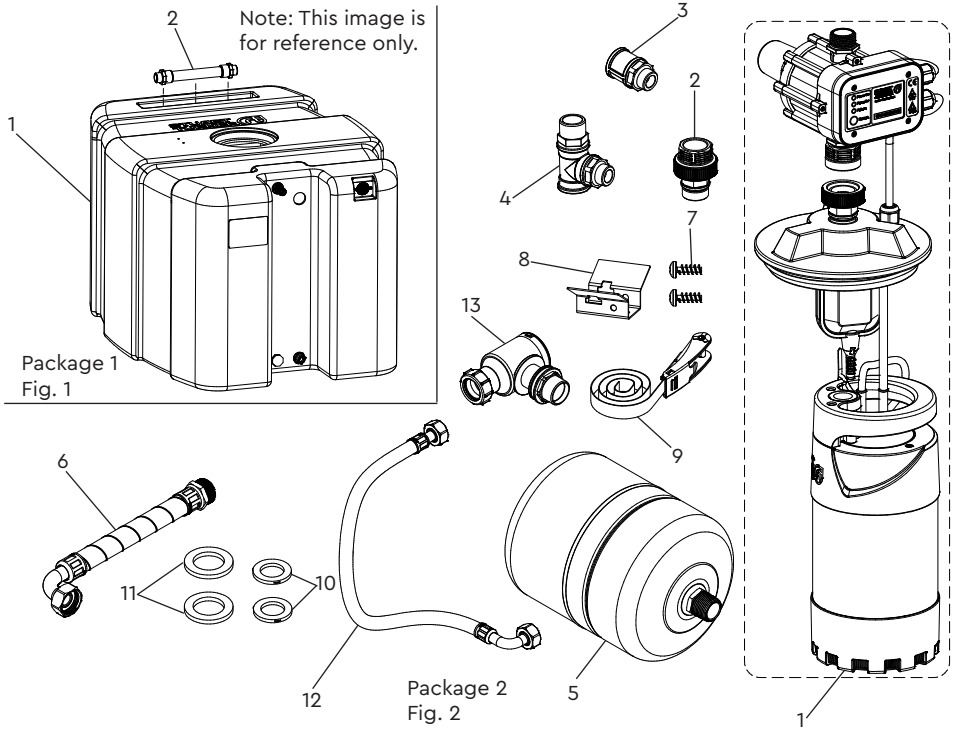

Item	Description	Qty	Item	Description	Qty
Package 1	1 Tank	1	Package 2 cont.....	7 6 mm Mounting screws	2
	2 Transfer pipe assembly	1		8 Vessel mounting bracket	1
Package 2	1 Pump, lid & controller assembly	1		9 Vessel mounting strap	1
	2 G 1 Union	1		10 G 3/4 Sealing washers	2
	3 Pressure vessel adaptor (G 1 F x G 3/4 M)	1		11 G 1 Sealing washers	2
	4 Tee assembly (G 1 F x G 1 M x G 3/4 M)	1		12 G 3/4 Transfer hose	1
	5 Pressure vessel	1		13 1 1/4 " Overflow	1
	6 G 1 Outlet hose	1			

Your product may vary slightly from the picture above.

Cont ...

1 IMPORTANT FACTS: READ BEFORE COMMENCING PUMP INSTALLATION

A Water storage capacity.



- 1.11 The iTank usable water volume can be found in the technical specification table (Section 8); the length of time the iTank delivers water will be dependent on the usage and refill rates.
- 1.12 Ensure the iTank is full of water before starting, to avoid causing damage to the pump shaft seal. See Section 6 – Commissioning.

B Water temperature

This unit is designed to pump cold water only which should not exceed the following values:

- 1.13 The maximum allowable water temperature is 23 °C (see Section 7.13).
- 1.14 The minimum allowable water temperature is 4 °C.

C Pipework – General

- 1.15 **Do not** drill holes or put fastenings into the iTank tank, this will cause leakage.
- 1.16 **System leaks:** Ensure the system to be boosted is able to hold pressure and is leak free before installing iTank. Failure to do so will cause abnormal operation and damage to the unit.
- 1.17 **Secure pipework:** Ensure pipework to and from pump is independently supported & clipped to prevent forces being transferred to inlet and outlet branches of the iTank. **Do not** secure pipework to the iTank, this will cause damage and possible leakage.
- 1.18 **Flux:** Solder joints must be completed and flux residues removed prior to iTank installation (**flux damage will void any warranty**).
- 1.19 **Pipework design:** Care should be taken in the design of pipework runs to minimize the risk of air locks e.g. use drawn bends rather than 90° bends.
- 1.20  **DO NOT** introduce solder flux to flexible hose, tank, pump or any parts manufactured from plastic.
- 1.21  **DO NOT** allow contact with oil or cellulose based paints, paint thinners or strippers, acid based descalents or aggressive cleaning agents.
- 1.22 **DO NOT** bend the flexible hose beyond 30°. It must be installed as straight as possible.
- 1.23 **DO NOT** feed other header or gravity tanks with iTank. It is acceptable to feed toilet cisterns provided the toilet fill valve operates correctly and is leak free.
- 1.24 All pipework must be suitably insulated as required.

D Plumbing Installation Regulations

- 1.25 The plumbing installation must comply with the current water and building regulations.
- 1.26 The plumbing installation must be installed by a qualified person.

E Pressure vessel

- 1.27 The iTank pressure vessel is charged at the factory see Section 7 – Maintenance for details.

Cont ...

2 LOCATION – GENERAL



- 2.11 **Access:** For emergencies and maintenance the pump must be easily accessible.
- 2.12 **Protection:** The iTank must be located in a dry, frost free area.
- 2.13 **Heat sources:** Separate the iTank from other appliances that generate heat.
- 2.15 **Water retention:** Site the iTank in a location where in the unlikely event of a water leak, any spillage is contained or routed to avoid electrics or areas sensitive to water damage. Drip trays are available for each model to protect from leaks and condensation. If the unit is intended for use in an attic space or above any critical area then a drip tray should be fitted (optional accessory available).
- 2.16 **Supply inlet pressure:** The water supply inlet pressure must be at least 0.2 bar and no greater than 10 bar; lower supply inlet pressures will reduce the tank fill rate and reduce the time the iTank will run at higher flow rates before running out of stored water.
- 2.17 **Ambient temperature:** The iTank must be sited in a location where the ambient temperature does not exceed 30 °C or below 4 °C (see Section 7.13 – Water Quality).
- 2.18 **Pipework:** For optimum performance outlet pipework must be 21 mm/³/₄ " pipe. Pipework should only reduce to 15 mm/¹/₂ " when entering terminal fittings.
- 2.19 **Static outlet pressure:** The static outlet head must also be within the maximum requirement of 12 metres (vertically above the appliance).
- 2.20 **Noise:** A flexible hose is supplied as standard which will minimise the transmission of noise and vibration from the iTank pump to the pipework connected to the appliance outlet. However, care must be taken when mounting the iTank that any noise is not amplified through loose panels or pipework.
- 2.21 **Direction of flow:** Ensure the water flow is in the direction of the arrow marked on the control module.
- 2.22 **Flexible hose:** Only use the Stuart Turner hose supplied with the pump.
- 2.23 **Isolating valves:** Separate system isolating valves (non restrictive) must be fitted to allow easy pump service. Isolating valves must be mounted where specified to allow the system isolation and removal of the iTank if needed. See Section 4 for installation details.

- 2.24 **Preferred iTank location:** The iTank must be located on a smooth level floor of sufficient strength to support the filled weight of the iTank, close to the water source and a suitable overflow position (see Section 8 – Technical Specification for filled weight). The iTank must not be installed solely on beams/joists, doing so will result in permanent damage to tank. The tank must be supported continuously along its base with no sharp or uneven parts that could pierce the tank.
- It must also be considered that the noise and vibration from the iTank may be transmitted through the structure the iTank is sited on.
- Ensure there is sufficient room above the iTank to allow the removal and servicing of the pump module and internal float valve and also enough room around the iTank to access all inlets/outlets.
- The unit should be located indoors and be protected from frost damage (insulation jacket option available).

3 KEY FEATURES

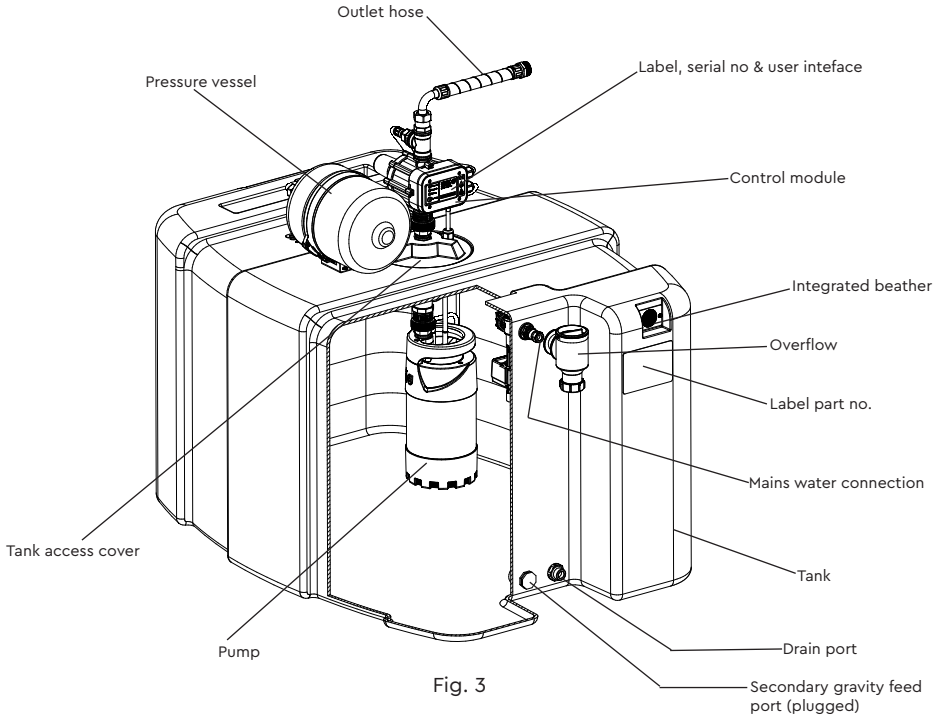

4 ASSEMBLY, INSTALLATION & CONNECTIONS

4.11 Stage 1 – Vessel Assembly:

Step 1

Secure mounting bracket to tank using factory drilled holes with supplied 6 mm screws. **Do not drill additional holes into the tank** (Fig. 4).

Step 2

Feed the strap through the slots in the bracket and place the pressure vessel on the bracket (Fig. 5).

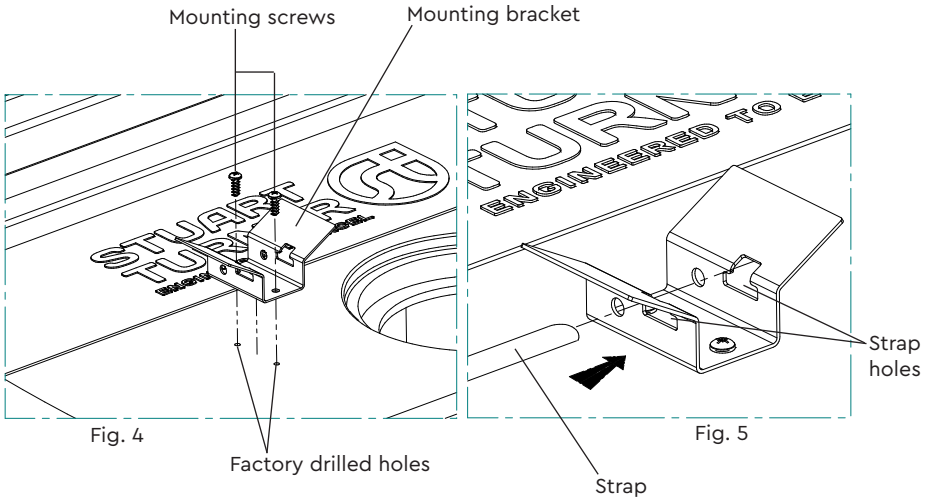

Step 3

Wrap the strap around the vessel and feed through the slot in the wratchet pin. If the slot is not positioned correctly to feed the strap through, operate the wratchet to rotate the pin (Figs 6 & 7).

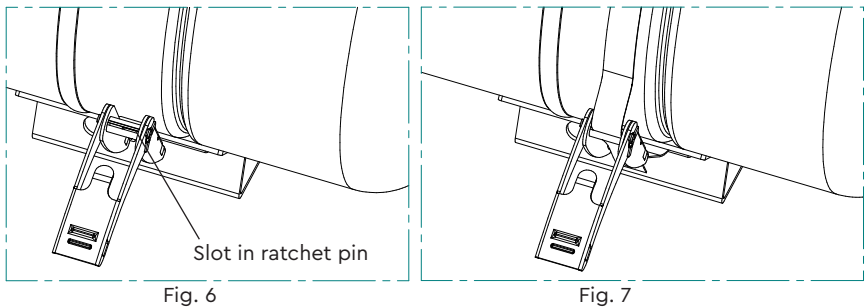

Cont ...

Step 4

Pull the strap through and apply tension then operate the wratchet to maintain the applied tension to secure pressure vessel, **do not over tighten**. Feed excess strap length under the vessel through the bracket to tuck it away (Figs 8 & 9).

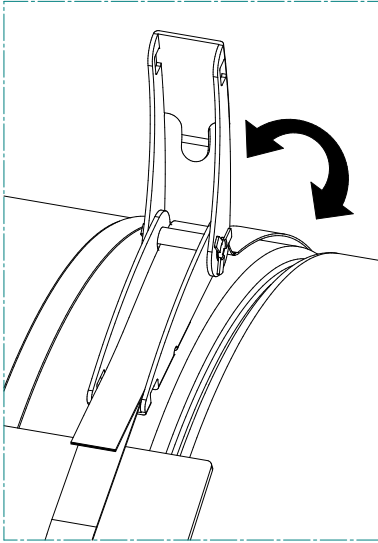

Fig. 8

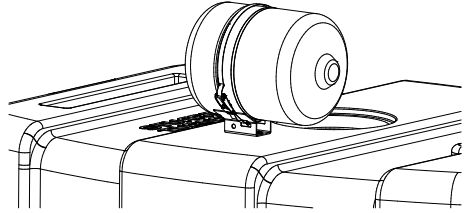

Fig. 9

4.12 Stage 2 – Pump Assembly:

Step 1

Assemble pump to underside of lid – ensure G 1 washer is properly placed in groove on underside of the lid (Fig. 10).

Step 2

Assemble control module to top of lid using pre installed union (Fig. 11).

Step 3

Assemble tee assembly to the control module using suitable thread sealant or PTFE tape and the outlet hose to the tee assembly using the supplied G 1 washer (Fig. 11).

Step 4

Place the assembly (Fig. 12) into the tank, screwing down the lid, and tighten the cable gland to secure the cable once the control module position relative the tank lid is set. The control module position may be adjusted using the union to ensure it is orientated towards the user. Ensure that the control module G 1 union is secured tightly to maintain a good seal (Fig 14).

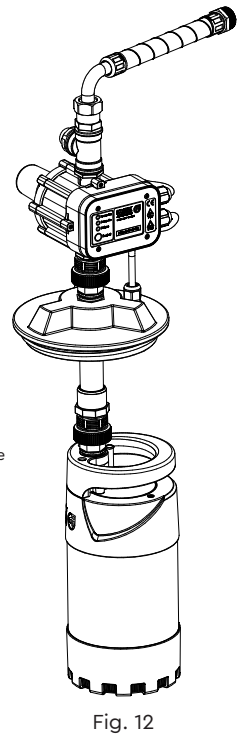
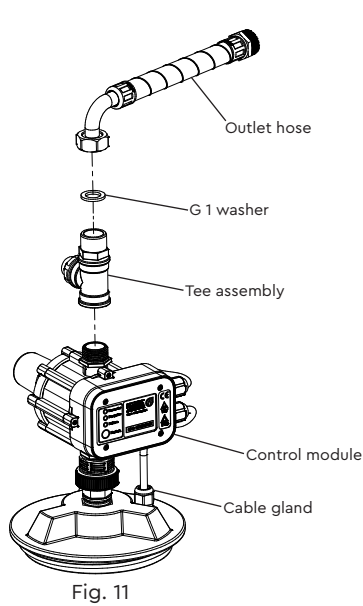
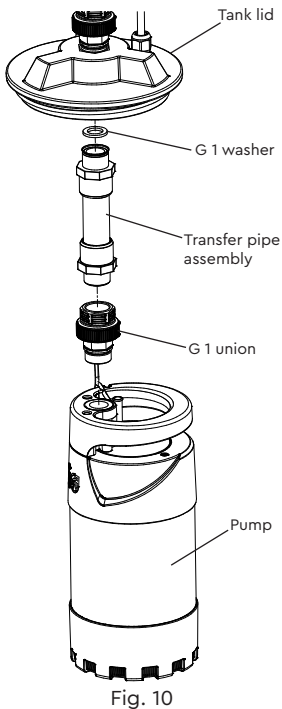

Cont ...

4.13 Stage 3 – Final Assembly:

Step 1

Install the provided 1¼ " overflow using the included overflow washer and nut (Fig. 13).

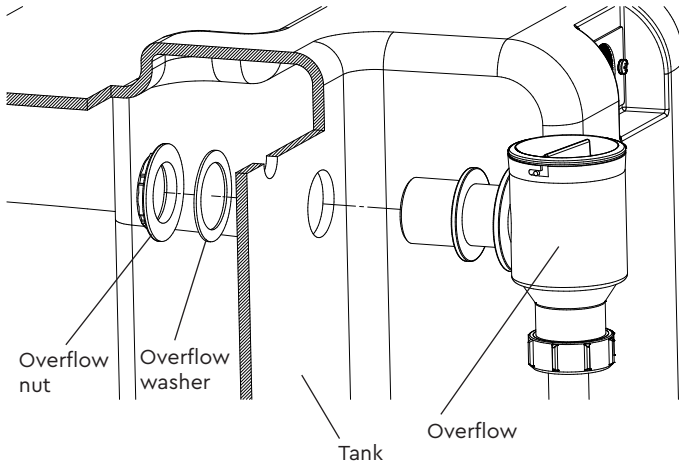

Fig. 13

Step 2

Connect pressure vessel to control module using included G ¾ hose, washers and adaptor (Fig. 14). The adaptor will need to be sealed using suitable thread sealant or PTFE tape.

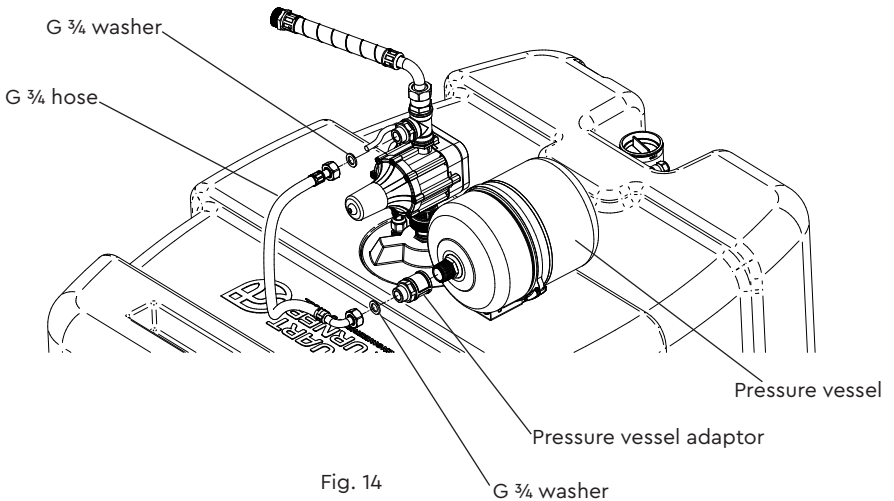
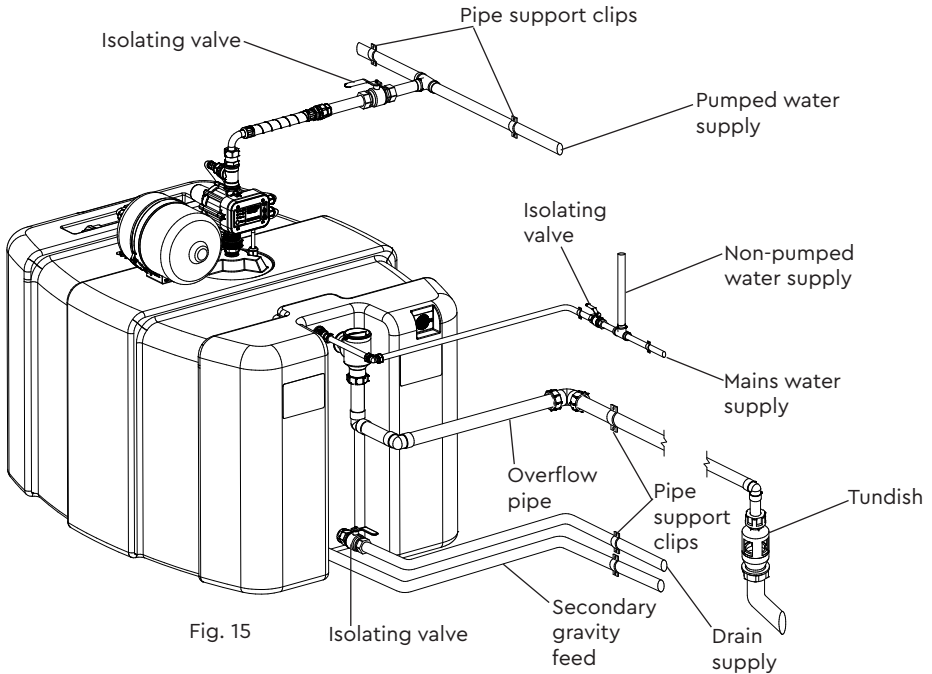

Fig. 14

Cont ...

- 4.14 **Mains water connection to iTank:** The iTank is to be permanently connected to the mains water supply using rigid pipe or suitably sized and rated flexible hose to comply with current building and plumbing regulations. The water tank fill valve has a ½ "/15 mm compression fitting. When tightening ensure the fill valve within the tank is not rotated. If the valve is rotated it may not function correctly with the risk of flooding.
- 4.15 **Connection to overflow/warning pipe:** The overflow fitting is designed to use G 1 ¼ (35 mm OD) plastic waste pipe. The overflow must be free to vent to atmosphere either via a tundish (Fig. 15) or a dedicated external pipe.
- 4.16 It is recommended that at least one drinking water tap is connected into the un-pumped mains water supply (typically a kitchen sink), so the water supply is maintained in the event of a failure of the pumped supply.
- 4.17 The iTank includes a G 1 F fitting as a gravity feed for uses where high pressure/high flow is not required such as filling of a toilet cistern. This port can be accessed by removing the sealed plastic plug and replaced with the appropriate fitting and sealed using suitable thread sealant or PTFE tape.



Cont ...

5 ELECTRICAL INSTALLATION / EARTHING



- 5.11 **Regulations:** The electrical installation must be carried out in accordance with the current national electrical regulations and installed by a qualified person.
- 5.12 In the interests of electrical safety a 30 mA residual current device (**R.C.D. not supplied**) should be installed in the supply circuit. This may be part of a consumer unit or a separate unit.
- 5.13 Before starting work on the electrical supply ensure power supply is isolated.
- 5.14 **DO NOT** allow the supply cord to contact hot surfaces, including the motor shell, pump body or pipework. The cord should be safely routed and secured by cable clips.
- 5.15 **Adjacent pipes:** Adjacent suction and delivery pipes should be fitted with earthing clamps in accordance with current regulations (Fig. 16).

Diagram
of earth
continuity
connections

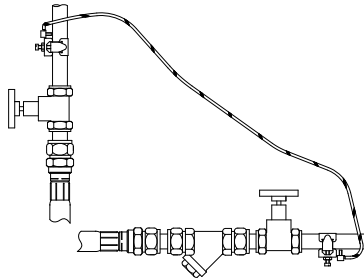

Fig. 16

- 5.16 **Earthing:** This appliance must be earthed via the supply cord, which must be correctly connected to the earth point located in the terminal box.
- 5.17 **Pipework:** Copper or metallic pipework must have supplementary earth bonding where the continuity has been broken by flexible hoses or plastic components.
- 5.18 **Additional earthing:** Certain installations may require additional earthing arrangements such as equipotential bonding. Reference should be made to the relevant regulations concerning this subject to ensure compliance.
- 5.19 **Connections:** The pump must be permanently connected to the fixed wiring of the mains supply using the factory fitted supply cord, via a double pole switched (with a minimum of 3 mm contact separation) fused spur off the ring main and **NOT** connected to the boiler or the immersion heater circuits.

5.20 Wiring of connection unit:



WARNING: This appliance must be earthed.

The wires in the mains lead (supply cord) are coloured in accordance with the following code:

- Green and Yellow: Earth
- Blue: Neutral
- Brown: Live

As the colours of the wires in the mains lead of this appliance may not correspond with the coloured markings identifying the terminals in your connection unit proceed as follows:

- The wire which is coloured green and yellow must be connected to the terminal in the connection unit which is marked with the letter E or by the earth symbol: \oplus or coloured green or green and yellow.
- The wire which is coloured blue must be connected to the terminal which is marked with the letter N or coloured black.
- The wire which is coloured brown must be connected to the terminal which is marked with the letter L or coloured red.

5.21 Wiring Diagram:

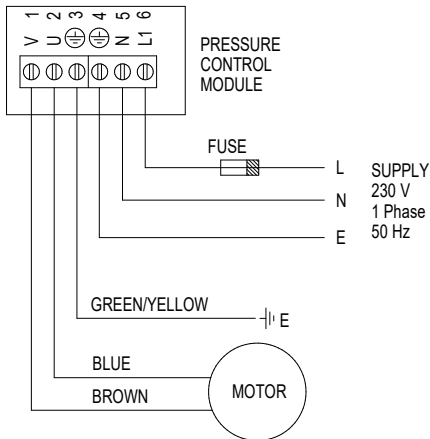

Fig. 17

5.22 **Fuses:** The following fuse size should be used:

Model	Fuse Size (AMPS)
All models	10

5.23 **Supply Cord Replacement:**



The supply cord and internal wiring within the terminal box are routed and secured to ensure compliance with the electrical standard EN 60335-1. It is essential that prior to any disturbance of this internal wiring, all cable routing and securing details are carefully noted to ensure re-assembly to the same factory pattern is always maintained.

If the supply cord is to be changed or is damaged, it must be replaced with a special cord assembly available from Stuart Turner or one of their approved repairers.

On disassembly note the cord retention and routing system. Re-assemble to the same pattern.

For information on cable connection consult the wiring diagram and cable gland fitting instructions.

5.24 **Cable Gland Fitting Instructions:**

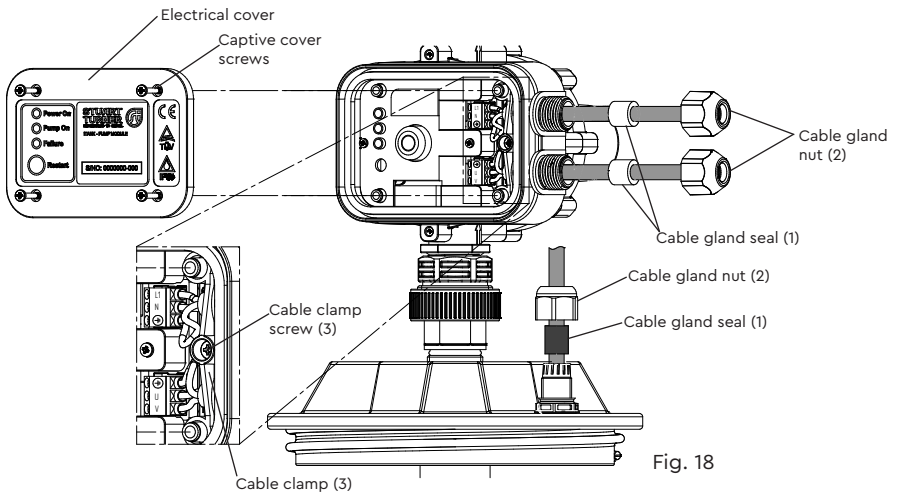

Fig. 18

To enable correct assembly of the cable glands, gland seals (1) must be placed over the cable before tightening the gland nuts (2) to prevent water/dust ingress. Ensure cable clamp (3) is installed and clamped on the outer cable insulation (not on the 3 wire cores) to ensure cable retention.

5.25 **Supply Cord Extension:**

The pumps are fitted with a supply cord to the following specification:-
 All models.HO7RN-F3 G 1.0 mm² – 10 Amp rated cable.
 If the supply cord is to be extended, a cord of the same specification should be used. Any connections or junction boxes used should be specifically suited for the application and installed in accordance with the manufacturers instructions.

Cont ...

6 COMMISSIONING / STARTING



6.11 System Flushing

The pipework system should be flushed out prior to the iTank being connected to ensure any contaminants/chemical residues and foreign bodies are removed from elsewhere in the system.

6.12 **Water Supply:** Always ensure that water supply is adequate to meet the demand. Ensure the tank is full of water before starting the pump. Failure to do this could result in seal damage. The pump should be fully submerged before starting. **Do not run pump dry.**

6.13 Unit starting and operation:

Starting

When the unit is connected to the electrical supply, the green led "**Power On**" lights up and the yellow led "**Pump On**" (pump in operation) indicates that the pump has been started.

Ensure all outlets are closed, turn the power supply 'on' – pump will start, pressurise the system and then stop. Open and close all outlets in turn associated with the pump (including w/c systems), allowing water to flow from each outlet until all air is purged. As each outlet is opened and closed, the pump will start and stop respectively.

If the FAILURE (red) L.E.D. lights up, this indicates that the pump is out of water or priming is incomplete. In the event of this happening, check water supply to pump. If all is in order keep the RESTART button depressed with a tap open and wait until the red failure light goes out. When the button is released and the tap closed, the control unit will stop the pump at its maximum pressure. **Do not run against a closed valve to periods longer than 5 minutes.**

Operation

Once the commissioning operation is completed, the module will perform all pump control operations automatically. Note: After closing any outlet there will be a small delay time before the pump stops operating, which is normal. Any tap or control valve within the system when opened and closed will now turn the iTank on/off, there will be a delayed start due to the water stored in the pressure vessel. Providing this is the case the system is now operating correctly. Carefully check pump and pipework for leaks whilst the pump is running and stationary before leaving the installation unattended.

Pump failure

When particular operational breakdowns occur, such as liquid failure, the module recognises the breakdown and the red L.E.D. FAILURE light comes on. The pump stops operating to prevent damage caused by its working in the absence of liquid. After rectification of the failure, the system is restarted by depressing the restart button.

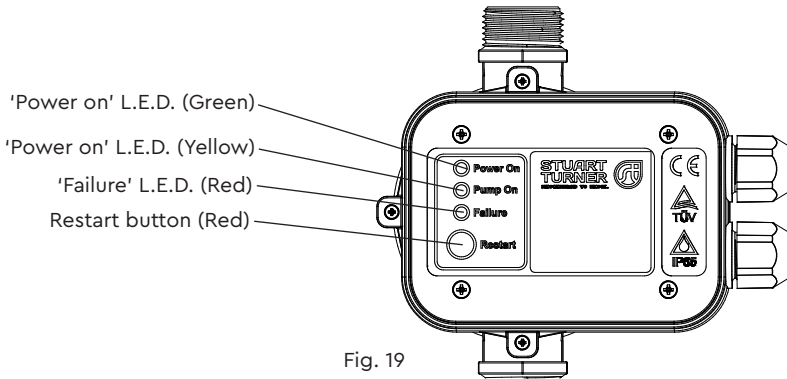

Fig. 19

6.14 **For Further Technical Support:** Phone the Stuart Turner TechAssist team on +44 (0) 800 31 969 80. Our staff are trained to help and advise you over the phone.

7 MAINTENANCE

- 7.11 **Pressure vessel:** The pressure vessel should be checked once every 12 months to have its pre-charge checked or replenished, this should be carried out as follows:-
- Isolate pump electrically.
 - Isolate the water supply by closing the appropriate isolating valves.
 - Release system water pressure by opening an outlet on the system.
 - Check pre-charge at Schrader valve (Fig. 20) using a tyre pressure gauge.
 - Replenish pre-charge by injecting air into the vessel via the Schrader valve using a car or bicycle pump (Fig. 20).
 - Close all system outlets, open inlet and outlet isolating valves.
 - After maintenance is completed refer to Section 6 – Commissioning for instructions on re-starting pump.

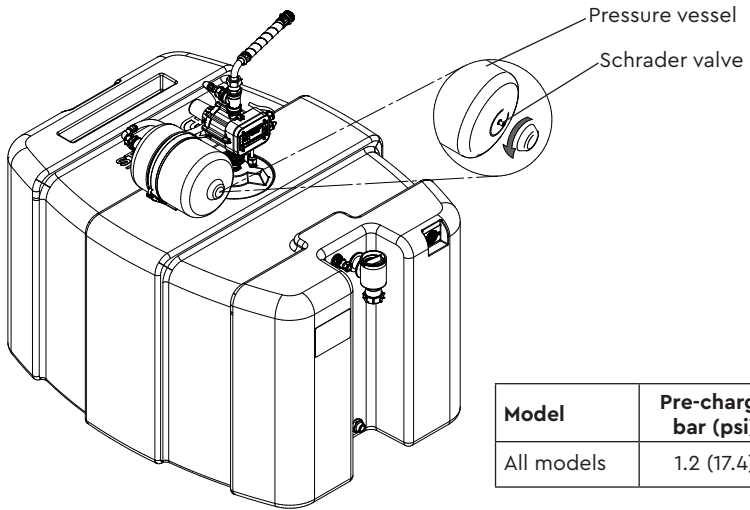

Fig. 20

- 7.12 **Water scale:** In areas of hard water, scale can cause the mechanical pump seal to stick if left without use for long periods. The pump must be run for at least 5 minutes every four weeks to "exercise" all working parts. See Section 8 – Technical Specification for note on water temperature.
- 7.13 **Water quality:** As with any stored volume of water; in order to ensure that the water remains fit for use the water temperature needs to remain below 20 °C. The quality of stored water will deteriorate with time and temperature. Bacterial growth is dependent on the water temperature, growth rates will be higher when the conditions are warm. To help control stored water temperatures, insulation jackets designed specifically for the iTank can be purchased from Stuart Turner.
- If the water remains unused for long periods of time, the tank should be drained and flushed through. The tank should be cleaned on an annual basis to protect against bacterial growth. If the iTank is installed in a rental property, it must be maintained in line with current Health & Safety regulations.

Cont ...

- 7.14 The tank can be drained by either:
- a) Isolating the mains water supply to the fill valve and using the pump to pump the water out of the tank.
 - or
 - b) Isolating the water supply to the tank and draining the water through the dedicated drain port (see Fig. 21).

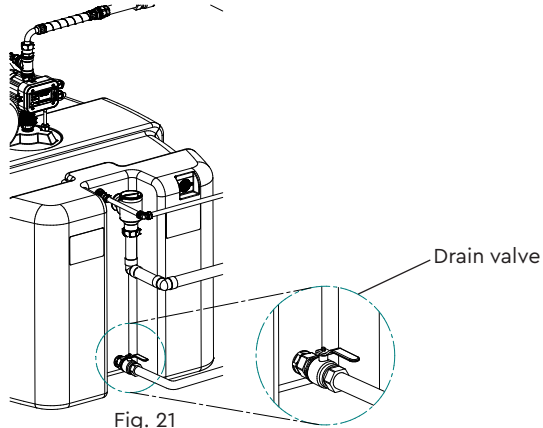

Fig. 21

- 7.15 **Control module keypad cleaning:** The control module cover is made from ABS, it must only be cleaned with warm soapy water or mild detergent. **Do not** use abrasive cleaners.
- 7.16 **Float fill valve:** The float level is factory set, but if in time the water level in the tank is found to be too high, the level can be adjusted by the valve screw stem (see Fig. 22). Access the float fill valve by removing the lid of the tank (see Section 3 – Key Features). The float height can be lowered by twisting the valve stem anti-clockwise.

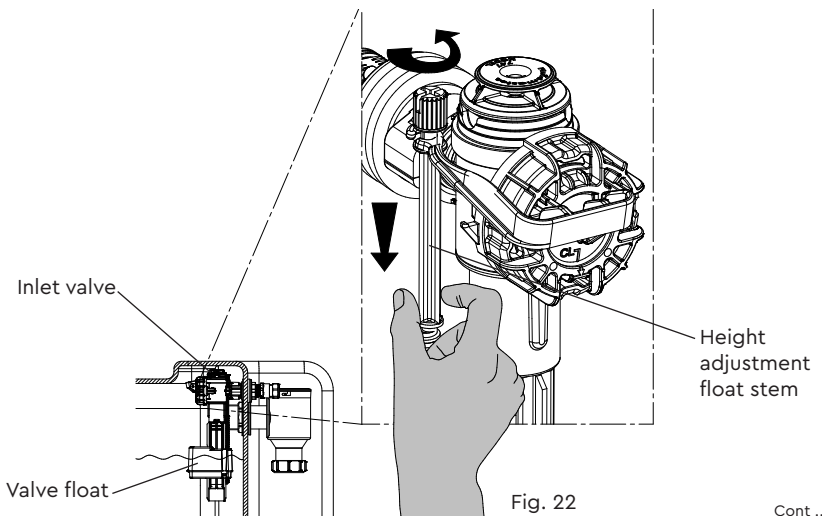

Fig. 22

Cont ...

8 TECHNICAL SPECIFICATION

		MBI 320C 47124	MBI 330T 47125	MBI 490A 47126	MBI 500S 47127
General	Guarantee	1 year			
	Approvals	CE			
Features	Pump control system	Fixed speed / control module			
	Pressure vessel	8 litres / 10 bar			
	Dry run protection	✓	✓	✓	✓
	System check valve	✓	✓	✓	✓
	Outlet flexible hose	✓	✓	✓	✓
Performance	Maximum head – closed valve	3.5 bar (35 metres)			
	Maximum flow	88 l/min	88 l/min	88 l/min	88 l/min
	Ambient air temperature	Min 4 – Max 30 °C			
Water tank	Nominal water tank size	417 litres	384 litres	547 litres	618 litres
	Usable water capacity	320 litres	331 litres	491 litres	503 litres
	Float valve type	Fluidmaster Pro 75B			
	Min/Max inlet valve pressure	0.2 bar / 10 bar			
	Water tank fill rate	4.2 l/min @ 1 bar			
	Water tank air gap	Type AC			
	Fluid category	CAT 3			
Connections	Inlet connection	½ "	½ "	½ "	½ "
	Outlet connection	G 1 M	G 1 M	G 1 M	G 1 M
	Outlet flexible hose	G 1 M x 300 mm			
	Overflow	1 ¼ " compression			
	Drain port	G ¾ M	G ¾ M	G ¾ M	G ¾ M
	Gravity secondary outlet	G 1 F	G 1 F	G 1 F	G 1 F
Materials	Water tank	Polyethylene			
Pump	Pump type	Submersible multistage centrifugal			
	Motor type	Induction, thermal protection			
	Duty rating	Continuous (S1)			
Electrical	Power supply (Vac/Ph/Hz)	3.7 A 230 V.a.c./1/50 Hz			
	Power consumption – P1	774 Watts			
	Power cable length	13 metres (pre-wired)			
	Enclosure protection	IP65 (control module)			
Physical	Width	500 mm	600 mm	650 mm	920 mm
	Depth	1575 mm	857 mm	1422 mm	1185 mm
	Height – excluding hoses	921 mm	1343 mm	1223 mm	1033 mm
	Weight – including fittings	48 Kg	44 Kg	51 Kg	54 Kg
	Weight – filled	368 Kg	375 Kg	542 Kg	557 Kg

Stuart Turner reserve the right to amend the specification without notice.

9 TROUBLE SHOOTING GUIDE

Symptoms	Probable Cause	Recommended Action
Pump will not start. Control module failure light illuminated.	Water supply low. Electrical supply. Static outlet head is greater than permitted.	Check water level in the supply tank and all stopcocks are open. Reset the control module by depressing the restart button. Check all electrical switches are on. Is the correct fuse fitted? Is the circuit breaker set? Outlet head is greater than 12 m, contact Stuart Turner.
Pump will not start.	Integral motor thermotrip activated. Pump jammed. Supply failure.	Wait for thermotrip to cool and auto-reset. Investigate cause of problem. Contact Stuart Turner. Restore voltage to pump.
The pump does not stop.	System leaks. Flow switch jammed. Restart button is jammed.	Check system for leaks by closing isolating valve on pump outlet while pump is running. If pump stops it confirms there is a condition in the system calling for the pump to run. Re-open outlet isolating valve and investigate cause for demand and rectify. Check float is not stuck. If the float cannot be reset, contact Stuart Turner. Press button repeatedly to free. Turn power off and on to reset control unit.
Pump surges.	Insufficient water supply to pump. Air is trapped in system. Blockage/restriction in pipework.	Check water level in supply tank and all stopcocks are open. Purge the system of air. Remove restriction.
Pump hunting (starting and stopping).	Failing non-return valve in control module.	Investigate and correct problem or replace the unit. Check system for leaks.

9.11 Dry Run Protection:

This pump is fitted with a safety control circuit, which will detect the following fault condition:

- **Dry running caused by water starvation to the pump.**

Should the pump run out of water it will stop as part of a protective logic sequence.

The fault should be rectified before re-starting the pump by pressing the reset button on the control module. Check that there is sufficient water supply to the tank and also ensure that all terminal fitting outlets are closed.

9.12 Environment Protection: Your appliance contains valuable materials which can be recovered or recycled.

At the end of the products' useful life, please leave it at an appropriate local civic waste collection point.

10 MAINSBOOST iTANK ACCESSORIES

10.11 Mainsboost iTank drip tray:

Designed to match the footprint of each tank profile and to protect against water damage from leaking inlet and outlet connections. Can also be used to provide a discharge connection that can be routed to a drain or soak-away.

<u>Part no.</u>	<u>Model</u>
29011	MBI 320C Drip tray
29012	MBI 330T Drip tray
29013	MBI 490A Drip tray
29014	MBI 500S Drip tray

10.11 Mainsboost iTank insulation jacket:

Mainsboost iTank insulation jackets are tailor-made to ensure a perfect fit and protect units from extremes of hot and cold temperatures.

<u>Part no.</u>	<u>Model</u>
29015	MBI 320C Insulation jacket
29016	MBI 330T Insulation jacket
29017	MBI 490A Insulation jacket
29018	MBI 500S Insulation jacket

11 THE MAINSBOOST iTANK GUARANTEE

Congratulations on purchasing a Stuart Turner product.

We are confident this product will provide many years of trouble free service as all our products are manufactured to the very highest standard.

The Mainsboost iTank is guaranteed to be free from defects in materials or workmanship for 1 year from the date of purchase.

Within the guarantee period we will repair, free of charge, any defects in the product resulting from faults in material or workmanship, repairing or exchanging the whole unit as we may reasonably decide.

Not covered by this guarantee: Damage arising from incorrect installation, improper use, unauthorised repair, normal wear and tear and defects which have a negligible effect on the value or operation of the product.

Reasonable evidence must be supplied that the product has been purchased within the guarantee term prior to the date of claim (such as proof of purchase or the product serial number).

This guarantee is in addition to your statutory rights as a consumer. If you are in any doubt as to these rights, please contact your local Trading Standards Department.

In the event of a claim please telephone '**TechAssist**' with proof of purchase and product serial number.

+44 (0) 800 31 969 80

You should obtain appropriate insurance cover for any loss or damage which is not covered by Stuart Turner Ltd in this provision.

Please record here for your records.

TYPE NO.	SERIAL NO.	DATE PURCHASED

NOTES

NOTES



DECLARATION OF CONFORMITY

Machinery Directive - 2006/42/EC

BS EN 12100, BS EN 809

Low Voltage Directive - 2014/35/EU

BS EN 60335-1, BS EN 60335-2-41

EMC Directive - 2014/30/EU

BS EN 55014-1, BS EN 55014-2, BS EN 61000-3-2, BS EN 61000-3-3,
BS EN 61000-4-2, BS EN 61000-4-3, BS EN 61000-4-4, BS EN 61000-4-5, BS EN 61000-4-6,
BS EN 61000-4-11

EMF Directive - 1999/519/EC

BS EN 62233

RoHs Directive - 2011/65/EU

WEEE Directive - 2012/19/EU

IT IS HEREBY CERTIFIED THAT THE STUART ELECTRIC MOTOR DRIVEN PUMP AS SERIAL NUMBER BELOW, COMPLIES WITH THE ESSENTIAL REQUIREMENTS OF THE ABOVE E.E.C. DIRECTIVES.



RESPONSIBLE PERSON
AND MANUFACTURER

STUART TURNER LIMITED
HENLEY-ON-THAMES, OXFORDSHIRE
RG9 2AD ENGLAND.

Signed

Engineering Manager

Stuart Turner are an approved company to BS EN ISO 9001:2015